

neat.bar pro



Go up a notch.

Neat Bar Pro packs a stack of tech into a simple and elegant device. Capable of driving three large screens, it allows you to enjoy an incredibly immersive higher-quality people and content experience throughout any meeting space. Neat Bar Pro is especially ideal for large meeting spaces as it incorporates two extreme resolution cameras and an advanced image depth sensor that combined deliver 16x zoom, so you're able to see everyone in full close-up, no matter where they are in the room.



Hear and be heard.

Neat Bar Pro is bursting with audio power, thanks to a woofer with two opposing drivers for vibration cancellation and three full-range speakers, which produce direct stereo sound throughout any room.

An advanced pyramid-shaped 16x microphone array ensures clear vocal pick-up, while Neat Audio Processing means no garbled 'double talk' issues or problems with background noise.

Reach further. Get closer.

Neat Bar Pro is especially ideal for bigger meeting spaces as its camera configuration incorporates a telephoto and wide-angle lens and an image depth sensor which combined deliver 16x zoom.

With lightning-fast image processing, Neat Bar Pro can detect, enlarge, and follow all in-room participants in full close-up, no matter where they're positioned, resulting in more lifelike engagement.



Simple set-up.

Everything you need is in the box, including a screen mount, making it easy for anyone to install and set up. Just plug in the two cables, and Neat Bar Pro automatically pairs with Neat Pad, our dynamic controller and scheduler, which comes as a package with Neat Bar Pro. Both Neat Bar Pro and Neat Pad can be connected wired or wirelessly to your network, so you can seamlessly share audio and visual content wirelessly or via an HDMI cable.

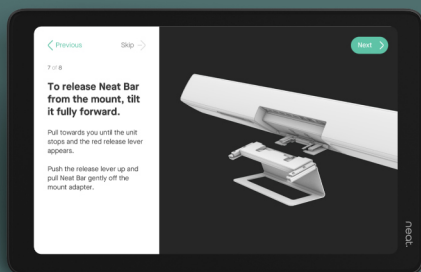



Audio extensible.

Neat Bar Pro will be audio extensible, too, giving you the option of connecting it to your existing AES 67 compatible systems. Finally, if you wish, you can deploy extra Neat Pad controllers throughout large rooms, empowering additional people to start a meeting, tap mute and more, or add Neat Pad schedulers to cover all entrances as well.

Neat removes complexities and threats thanks to our secure, single-purpose hardware devices. Hence, no stressing about passwords and patches. Plus, you can install all the latest upgrades with just one click.

Neat Bar Pro is available for pre-order now and will begin shipping on November 30, 2021.



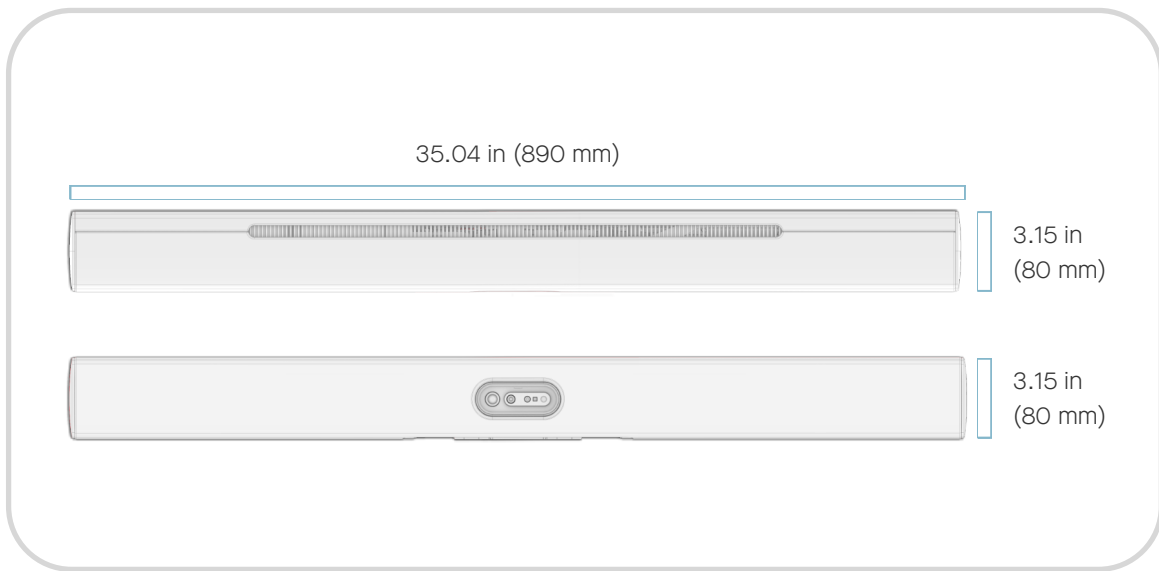

Neat Bar Pro

Wake-up sensor (radar)
Depth sensor (time-of-flight VGA 60° FOV)
Orientation sensor (accelerometer)
Ambient light sensor
Temperature sensor
Humidity sensor
Air quality sensor
Camera LED
System LED
Tripod mount compatible (1/4-20 UNC threads)
Table stand, wall mount and screen mount

Audio

Speakerbox for maximal tonal range with minimal distortion
3 full-range speakers primed for directional and stereo sound
Subwoofer with two opposing drivers for vibration cancellation
6 tracking mics
16 microphones for beamforming arrays
Hardware-accelerated audio processing
Echo cancellation
Noise suppression
Automatic gain control
Dereverberation

Security

Secure boot
Security lock slot
Communications are established with 256-bit TLS encryption
Shared content is encrypted with AES-256 encryption
The Zoom Rooms app is secured with App Lock Code
As a native Zoom device, Neat Bar Pro supports all Zoom signaling and media encryption protocols.
Read more about [Zoom security](#).

Video

Pro 100 MP camera system with wide and tele-cameras
Wide camera: 50 MP, $f/2.8$ aperture, 113° horizontal field of view
Tele-camera: 50 MP, $f/1.8$ aperture, 70° horizontal field of view
Hybrid zoom up to 16x
Hardware-accelerated video encode and decode
Distortion correction
Noise reduction
Chromatic aberration correction
Automatic white balance and color correction
People video resolution: Up to 1080p / 30
Content video resolution: 720p / 60, 1080p / 30

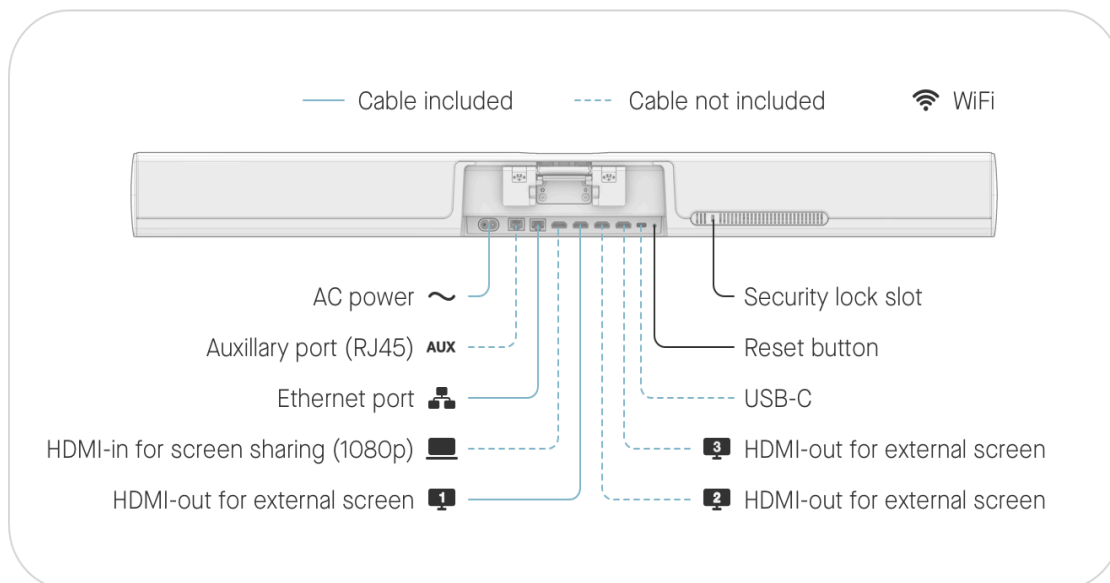

Electrical and environmental requirements

Built-in power supply
 100 - 240 V AC, 50 Hz to 60 Hz
 Ambient operating temperature: 32° to 95° F (0° to 35° C)
 Storage temperature: 5° to 149° F (-15° to 65° C)
 Relative humidity: 20% to 80%

Size and weight

Width: 35.04 inches (890 mm)
 Height: 3.15 inches (80 mm)
 Depth: 3.15 inches (80 mm)
 Weight: 6.83 pounds (3.1 kg)

What you'll need

Subscription service with Zoom or Microsoft Teams (**)
 Display with HD capability or better
 Internet connection

Networking and Ports

WiFi
 Ethernet
 AC power (internal power supply)
 USB-C for input when connected to a touch screen
 3x HDMI out for external screens
 HDMI-in for screen sharing
 Auxiliary port for third-party audio extensions (RJ45) (*)

What's in the box

Neat Bar Pro
 HDMI cable (6.5 feet / 2 meters)
 Ethernet cable (9.8 feet / 3 meters)
 Power cable (9.8 feet / 3 meters)
 Mount adapter, wall mount, screen mount and table stand

4x M8 screw (0.94 inches / 24 mm) for VESA mount
 4x M6 screw (0.94 inches / 24 mm) for VESA mount
 2x spacer (to secure parallel TV mount)
 1x 5 mm hex key for the screen mount
 1x 2 mm hex key for the mount adapter

2 additional screw bags for dual or triple screen setup

4x M8 screw (0.94 inches / 24 mm) for VESA mount
 2x 4x M8 screw (0.94 inches / 24 mm) for VESA mount
 4x M8 screw (0.94 inches / 24 mm) for VESA mount

* Supported in a future software update

** Needs to be purchased from Zoom or Microsoft

Neat Pad

8-inch (diagonal) touch screen

Anti-glare, anti-smudge coating

Side LED Indicators

2 microphones*

Wall mount & side mount

Zoom Rooms software

WiFi

Power over Ethernet (PoE) or powered by included power injector

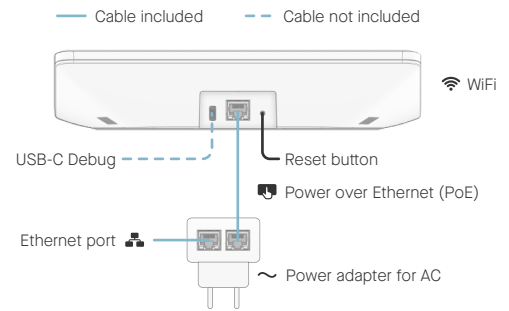

7.8 in (198 mm)

